

QUALITY ^{RIEDEL} DOORS AND OPENERS

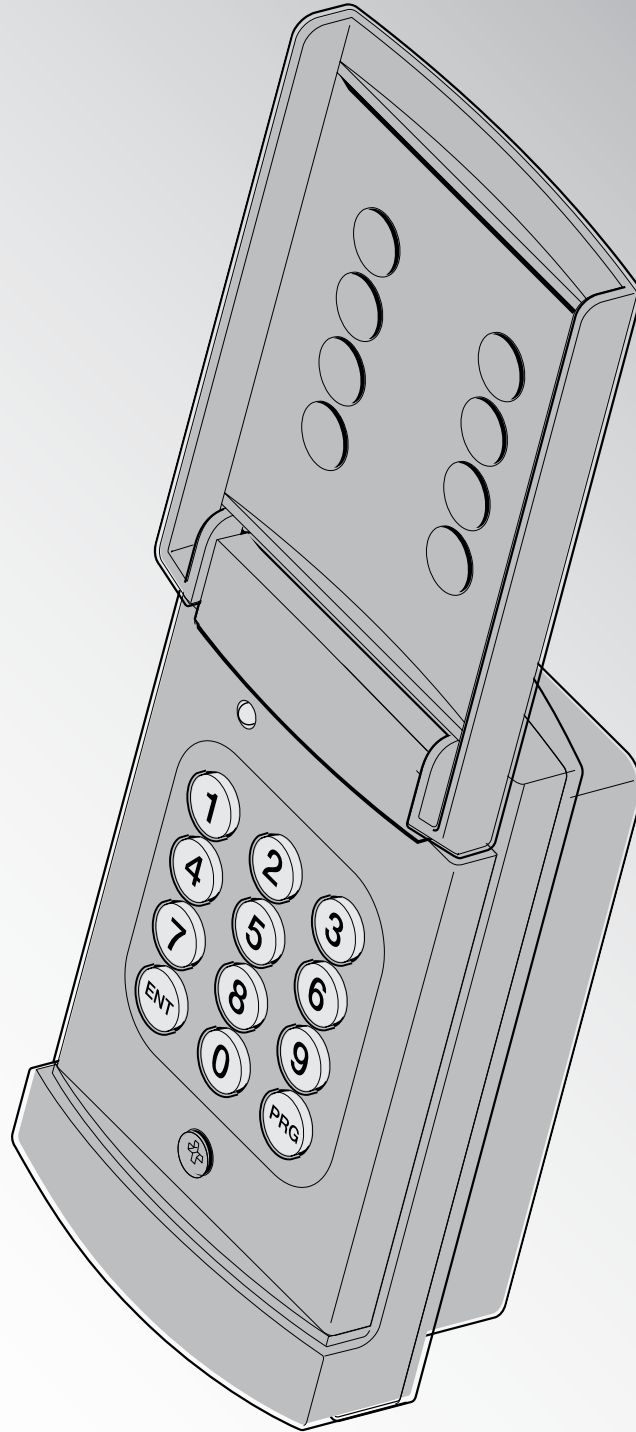

Owner's Manual & Instructions
Hörmann Covered Wireless Keypad Model FCT3b

Wireless Keypad FCT3b

Features:

- Control up to 3 openers with up to 3 programmable 4-digit PIN codes.
- The buttons on the keypad are illuminated for ease of use in low light situations.
- 4 billion different radio code possibilities for your safety and security.
- After a valid PIN entry the keypad illuminates for 20 seconds in which a press of any button except the PRG-button will operate the garage door.
- The keypad is covered for protection against the elements.

USA: FCC ID: PZI-315FCT3B

Canada: IC: 4205A-315FCT3B

This device complies with Part 15 of the FCC Rules and with RSS-210 of Industry Canada.

Operation is subject to the following two conditions:

- (1) This device may not cause harmful interference, and
- (2) This device must accept any interference received, including interference that may cause undesired operation.

CAUTION!

Changes or modifications made to this equipment not expressly approved by Hörmann may void the FCC authorization to operate this equipment.

The radiated output power of the FCT3b with operating frequencies 315 MHz is far below the FCC radio frequency exposure limits. Nevertheless, the FCT3b operating frequencies 315 MHz shall be used in such a manner that the potential for human contact during normal operation is minimized.

IC: before the equipment certification number signifies that the Industry Canada technical specifications were met. It does not guarantee that the certified product will operate to the user's satisfaction.

Important Information

Read and follow these instructions carefully. They provide important information for the safe installation and operation of your FCT3b.

Please also follow the instructions to ensure safe operation of the operator and door. Keep these instructions in a safe place so that you can refer to them as needed.

Only drive through or walk under a remote controlled door if the door is stationary and in the "fully-open" position.

Only use the FCT3b when the door is within sight.

When installing the FCT3b, use only original components.

Observe local safety regulations, especially where a 120 V AC power supply is concerned.

Any work should be carried out by a qualified electrician.

- To ensure proper operation, all equipment should be protected from direct sunlight, moisture or dirt.
- The FCT3b has a temperature tolerance from -4 °F to +140 °F.

If more than one radio receiver is required, make sure that these are mounted at least 3 feet from each other.

NOTE:

Local conditions can affect the range of the remote signal.

Wireless Keypad FCT3b

I. PROGRAMMING

1. Press and release the P-button on the bottom of the Power Head. The red LED located on the Power Head starts to blink slowly for 20 seconds.
 2. Within these 20 seconds enter a 4-digit PIN on the keypad.
 3. Press the ENT-button to finish the programming (Stay within 3 ft. from the Power Head during this step).
- To program the second and third code repeat the steps 1-3.

II. OPERATION

1. Enter a valid PIN using the numeric buttons.
2. Press the ENT-button.

If a valid entry has been made the LED on the FCT3b flashes very fast and a radio code is transmitted.

III. CHANGING PIN

1. Press and release the PRG-Button.
2. Enter the PIN you want to change.
3. Press and release the PRG-Button.
4. Enter the new 4-digit PIN.
5. Press and release the PRG-Button.

The LED gives a long signal if a valid entry has been made.

IV. RESETTING TO FACTORY SETTINGS

After Factory reset all existing PIN numbers are cleared.

1. Take the battery out of the FCT3b.
2. Wait for approximately 10 seconds.
3. Press and hold the 0-button and reinsert the battery.
4. The red LED flashes fast.
5. Continue to hold the 0-button until the red LED stops flashing.
6. Release the 0-button. The FCT3b has now been reset to the factory settings.

V. CHANGING THE BATTERY

The keypad uses a standard 9 V block battery. The battery should be changed if the light of the keypad becomes dim during operation.

1. Remove the Phillips screw underneath the 0-button.
2. Take the old battery out of the FCT3b
3. Wait for approximately 10 seconds
4. Connect the new battery

All previously programmed PIN codes are retained during the battery change.

VI. INSTALLATION



NOTE:

Before permanently installing the FCT3b be sure that the chosen location allows the radio signal to be properly received.

WARNING

- ▶ **WORK SAFELY.** Always wear appropriate safety protection when using any tools.
- ▶ The FCT3b must be securely installed in sight of the door but away from any moving parts.
- ▶ The FCT3b must be installed out of reach of children (minimum height: 5 ft).

Choose an installation location for the FCT3b well away from existing cables and appliances with mains voltage (see Fig. 1).

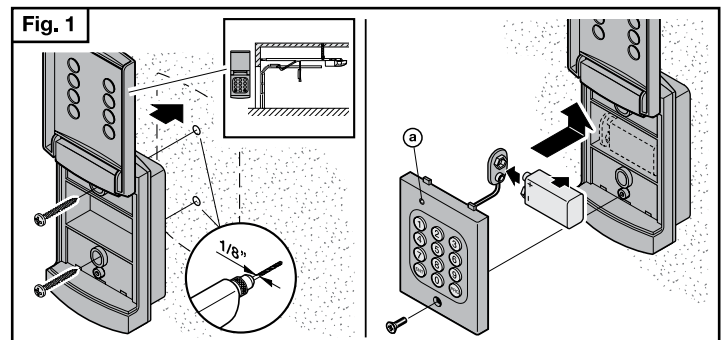

Everything you've always wanted in a garage door, and more.



German Engineered, American Made

Our promise to you.

As one of the world's leading manufacturers of doors, we're committed to providing the best quality, value, and selection. Whether residential or commercial, whether steel or high density polyethylene,

whether traditional or contemporary, we have the door you're looking for. Each Hörmann door gives you the perfect array of benefits and options, with the drive to match.



Hörmann LLC, Montgomery, IL



Hörmann Flexon LLC, Leetsdale, PA

For assistance and service call 1-877-OK-HORMANN (1-877-654-6762)



Environmental commitment has been part of our corporate culture for decades, from our manufacturing processes to the products we make.

In everything we do, we strive to minimize energy and resource use, through efficient processes long-lasting quality and innovative engineering.

Hörmann LLC, 5050 Baseline Road, Montgomery, Illinois 60538
Phone: 630-859-3000 Toll-Free: 1-877-654-6762 Fax: 630-859-8122
Email: info@hormann.us www.hormann.us

