



EN **Electrical Installation Manual**
Dock Leveler Control: Basic

LIMITED LIABILITY!

© Copyright 2024 by
Hörmann Flexon LLC
Westport Ridge Park
251 Solar Drive
Imperial, PA 15126-3708
Phone: 724.385.9150
www.hormann.us

This edition replaces all earlier versions.

The collecting of information in this document has been done to the best of our knowledge and with due diligence. Hörmann Flexon LLC does not warrant the correctness and completeness of the information in this document. In particular, Hörmann Flexon LLC cannot be held liable for following damages due to faulty or incomplete information. Since mistakes can never be completely avoided in spite of our best efforts, we always welcome feedback.

The installation recommendations contained in this document presume favorable surrounding conditions. Hörmann Flexon LLC assumes no liability for perfect function in environments alien to the system. Hörmann Flexon LLC provides no warranty that the information in this document is free of foreign copyrights. Hörmann Flexon LLC does not grant any licenses for its own or foreign patents or other copyrights in connection with this document. Warranty claims against Hörmann Flexon LLC are the right of the direct contractual partner only and are not transferable. Warranty is assumed only for the products supplied by Hörmann Flexon LLC. There is no warranty for the overall system. The description of products, their use, possibilities, and performance data are not to be taken as assured properties and are subject to technical changes.

Table of Contents

1. Performance Specification	3
2. Validity	3
3. Certifications	3
4. General Notes	3
5. Safety Instructions	3
6. Technical Data	4
i. Mechanical Data	4
ii. Electrical Data	4
7. Installation	5
i. Mechanical Installation	5
ii. Electrical Installation	6-7
8. Operation	8

1. Performance Specification

The simple dock leveler controller is a constant pressure contact system used to operate a hydraulic valve dock leveler system.

2. Validity

This manual is valid for the following models.

- Dock Level Control Basic 1Φ: 120V
DLC-B11 #10000201
- Dock Level Control Basic 1Φ: 230V
DLC-B13 #10000203
- Dock Level Control Basic 3Φ: 208V
DLC-B32 #10000199
- Dock Level Control Basic 3Φ: 230V
DLC-B33 #10000205
- Dock Level Control Basic 3Φ: 460V
DLC-B34 #10000207

3. Certifications

UL File #E202315 – Motor Controllers, Magnetic – Component
UL Rating: UL508

4. General Notes

- The rules for prevention of accidents as well as operating and installation instructions when installing and commissioning are to be observed.
- Connecting, testing and maintenance work on the system should only be done when the dock is not in use. Observe especially those items indicated under safety instructions.
- Cable connections to the control system should be short and lead directly to the connecting terminal, (no kinks or loops)
- All Connections are to be made with copper wiring.

5. Safety Instructions

- All installation, startup and maintenance work must be performed only by qualified specialists.
- All electrical work must be performed in accordance with local and state building codes.
- All electrical work must be performed under **Lock Out Tag Out** conditions.
- These safety advisories make no claim to completeness. If you have questions about the product, contact your vendor.

⚠WARNING
Failure to observe the safety advisories can result in physical harm or damage.

6. Technical Data

i. Mechanical Data

Controller Variant	DLC – B11	DLC – B13	DLC – B32	DLC – B33	DLC – B34
Enclosure Type	NEMA 4/4X	NEMA 4/4X	NEMA 4/4X	NEMA 4/4X	NEMA 4/4X
Dimensions (W x H x D)	4.49 x 8.54 x 4.43 In. 114 x 217 x 112.5 mm.	4.49 x 8.54 x 4.43 In. 114 x 217 x 112.5 mm.	4.49 x 8.54 x 4.43 In. 114 x 217 x 112.5 mm.	4.49 x 8.54 x 4.43 In. 114 x 217 x 112.5 mm.	4.49 x 8.54 x 4.43 In. 114 x 217 x 112.5 mm.
Protection Type	UL – Type Rating	UL – Type Rating	UL – Type Rating	UL – Type Rating	UL – Type Rating
Weight	2.0 lbs. / 1.0 kg	2.0 lbs. / 4.6 kg	2.0 lbs. / 1.0 kg	lbs. / 4.6 kg	10 lbs. / 4.6 kg
Installation Position	Vertical Use Only	Vertical Use Only	Vertical Use Only	Vertical Use Only	Vertical Use Only
Vibration	Low Vibration mounting, for example on a concrete wall	Low Vibration mounting, for example on a concrete wall	Low Vibration mounting, for example on a concrete wall	Low Vibration mounting, for example on a concrete wall	Low Vibration mounting, for example on a concrete wall
Cable Entries	Bottom of Enclosure, Top allowable for power. Conduit	Bottom of Enclosure, Top allowable for power. Conduit	Bottom of Enclosure, Top allowable for power. Conduit	Bottom of Enclosure, Top allowable for power. Conduit	Bottom of Enclosure, Top allowable for power. Conduit
Temperature Range	-4°F TO +131°F (-20°C TO +50°C)	-4°F TO +131°F (-20°C TO +50°C)	-4°F TO +131°F (-20°C TO +50°C)	-4°F TO +131°F (-20°C TO +50°C)	-4°F TO +131°F (-20°C TO +50°C)
Storage	-58°F TO +176°F (-50°C TO +80°C)	-58°F TO +176°F (-50°C TO +80°C)	-58°F TO +176°F (-50°C TO +80°C)	-58°F TO +176°F (-50°C TO +80°C)	-58°F TO +176°F (-50°C TO +80°C)
Altitude	<6500 ft (2000m)	<6500 ft (2000m)	<6500 ft (2000m)	<6500 ft (2000m)	<6500 ft (2000m)

ii. Electrical Data

Controller Variant	DLC – B11	DLC – B13	DLC – B32	DLC – B33	DLC – B34
Main Supply (Input)	1Φ 120V	1Φ 230V	3Φ 208V	3Φ 230V	3Φ 460V
Short Circuit Current Rating	5kA	5kA	5kA	5kA	5kA
Amperage Rating	13A	10A	7A	7A	5A
Horsepower	0.75kW	0.75kW	0.75kW	0.75kW	0.75kW
Connection Type	Screw Terminal	Screw Terminal	Screw Terminal	Screw Terminal	Screw Terminal

7. Installation

i. Mechanical Installation

- Do not exceed permissible loads on walls as well as connecting and transmission elements.
- Choose Suitable connecting elements for attachments to the mounting surface.
- Mount enclosure Vertically.
- Located on the enclosure. There are (4) entry points with predetermined knockouts. Determine best entry point for the installation.



Diagram: Basic Controller

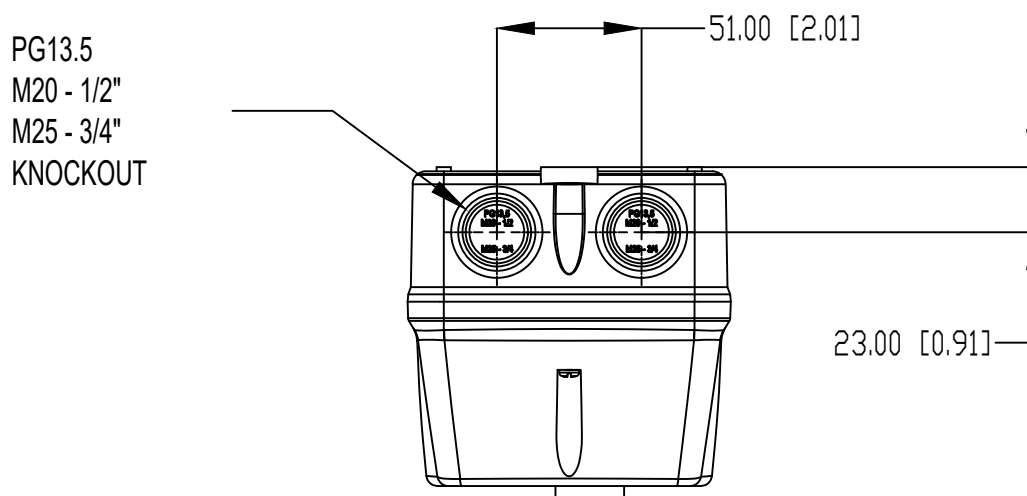

ii. Electrical Installation
 i. Single Phase Connections

Input Connections	
1L1	Line Wire
5L3	Neutral Wire
GND	Ground Wire

Output Connections	
2T1	Black #1
6T3	Black #2
GND	Green / Yellow

*POWER CABLE **NOT** PROVIDED.
 *MOTOR CABLE ATTACHED WITH
 PRECONFIGURED MOTOR SETTINGS FOR THE
 INTENDED INSTALLATION*

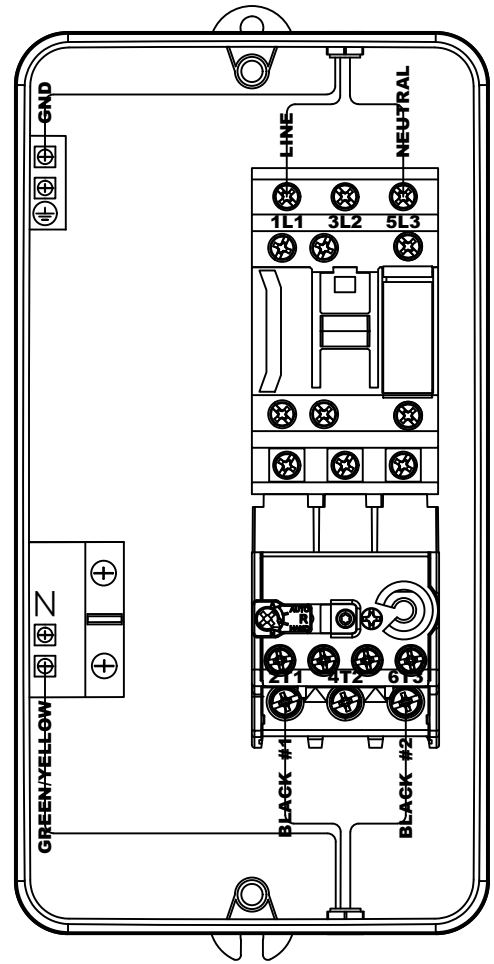

Diagram: Connections [1PH]

3PH Motor Configurations

Voltage	Configuration	Amperage	Frequency	Cos ϕ	kW
1PH 120V	Delta	10.3A	60	0.98	0.75
1PH 230V	Wye	7.3A	60	0.84	0.75

ii. Three Phase Connections

Input Connections	
1L1	Line 1
3L2	Line 2
5L3	Line 3
GND	Ground Wire

Output Connections	
2T1	Red
4T2	White
6T3	Black
GND	Green / Yellow

*POWER CABLE **NOT** PROVIDED.
 *MOTOR CABLE ATTACHED WITH
 PRECONFIGURED MOTOR SETTINGS FOR THE
 INTENDED INSTALLATION*

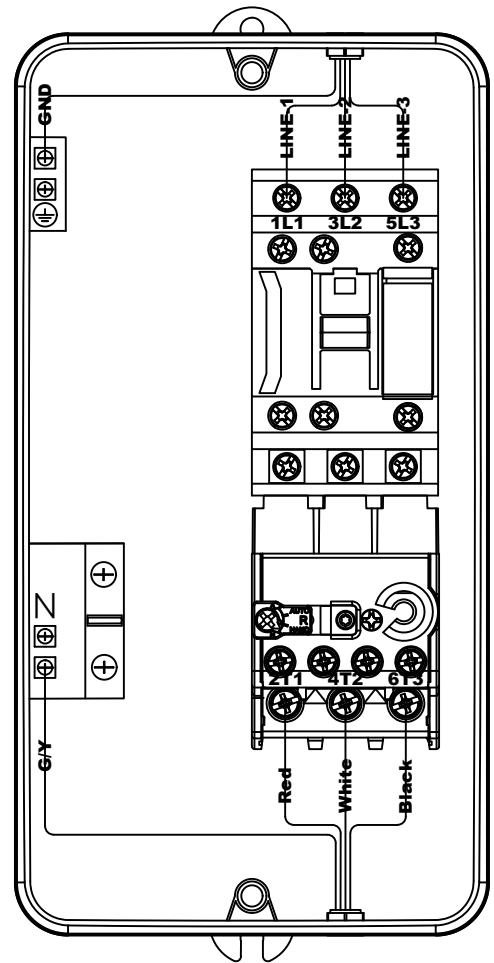

Diagram: Connections [3PH]

3PH Motor Configurations

Voltage	Configuration	Amperage	Frequency	Cos ϕ	kW
3PH 208V	Delta	5.00	60	0.58	0.75
3PH 230V	Delta	5.00	60	0.58	0.75
3PH 460V	Delta	2.50	60	0.57	0.75

8. Operation

Once the installation is complete.

Remove LOTO devices. Apply power to the system.

Operational Commands:

1. Hold [GREEN] Button: Activation of Dock Leveler Platform.
2. Hold [RED] Button: Resets (Motor Overload Relay).

Operational Test:

1. **Hold** [GREEN] Button: Time Duration (<3s)
Dock platform raises from home position, returns home.
2. **Hold** [GREEN] Button: Time Duration (>3s)
Dock platform raises from home position, lip is fully extended. Lip retracts, Dock Platform descends. Platform falls to lower position.
3. **Hold** [GREEN] Button: Time Duration (<3s)
Dock platform raises from lower position, lip does not extend. Platform returns to home position.

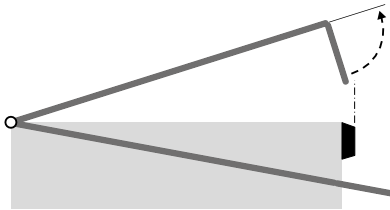
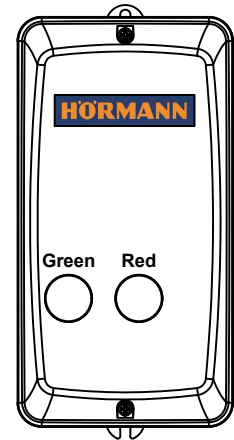

HÖRMANN NORTH AMERICA



Sparta, TN - North American Headquarters / Sectional Doors

SIX PRODUCTION PLANTS, ONE FAMILY

As one of the world's leading manufacturers of door systems, we're committed to providing the best quality, value, and selection. Whether residential, commercial or industrial, we have the solutions you're looking for. Each Hörmann product gives you the perfect array of benefits and options to satisfy your customers.



Puyallup, WA



Montgomery, IL



Barrie, ON Canada



Burgettstown, PA



Imperial, PA

USA

Toll Free: 800.365.3667
 Email: info@hormann.us
 Website: hormann.us

Canada

Toll Free: 866.792.9968
 Email: info@hormann.ca
 Website: hormann.ca

Mexico

Toll Free: 52 (81) 8308 7481
 Email: info@hormann.com.mx
 Website: hormann.mx



AVAILABLE FROM:



Follow us on social media



HÖRMANN

We reserve the right to change specifications without notice. ©Hörmann (Issue 11.2024)